

## 1972-73 SUBARU

1300 (1972)  
1400 (1972-73)

### DESCRIPTION

Steering gear, mounted on crossmember, is a rack and pinion type, with backlash automatically adjusted. Pinion is connected to steering shaft by a flexible rubber coupling. Steering knuckle arms are connected to rack by tie rods which are threaded onto ball joint studs at each end of rack.

### ADJUSTMENT

**Backlash** – Backlash is automatically held to a minimum by a spring loaded sleeve which bears against rack. Adjustment is not normally required. End play of sleeve may be corrected if necessary by turning adjusting screw in until it contacts plate, and then backing screw out 1/8 turn to obtain .006" (0.16 mm) end play. Tighten lock nut.

### REMOVAL & INSTALLATION

**Removal** – 1) Raise vehicle and remove front wheels. Remove tie rod ends from steering knuckles. Remove parking brake cable hanger from tie rod. Disconnect pinion from steering shaft rubber coupling. Straighten lock plates and remove bolts retaining gear assembly to crossmember.

2) Loosen front engine mounting bolts and raise engine about 0.2" (5 mm) to clear gear assembly. Remove gear assembly from crossmember (toward left side). Remove mounting brackets.

**Installation** – To install, reverse removal procedure and note the following: Tighten all bolts and nuts to specifications and secure with lock plates or cotter pins as required.

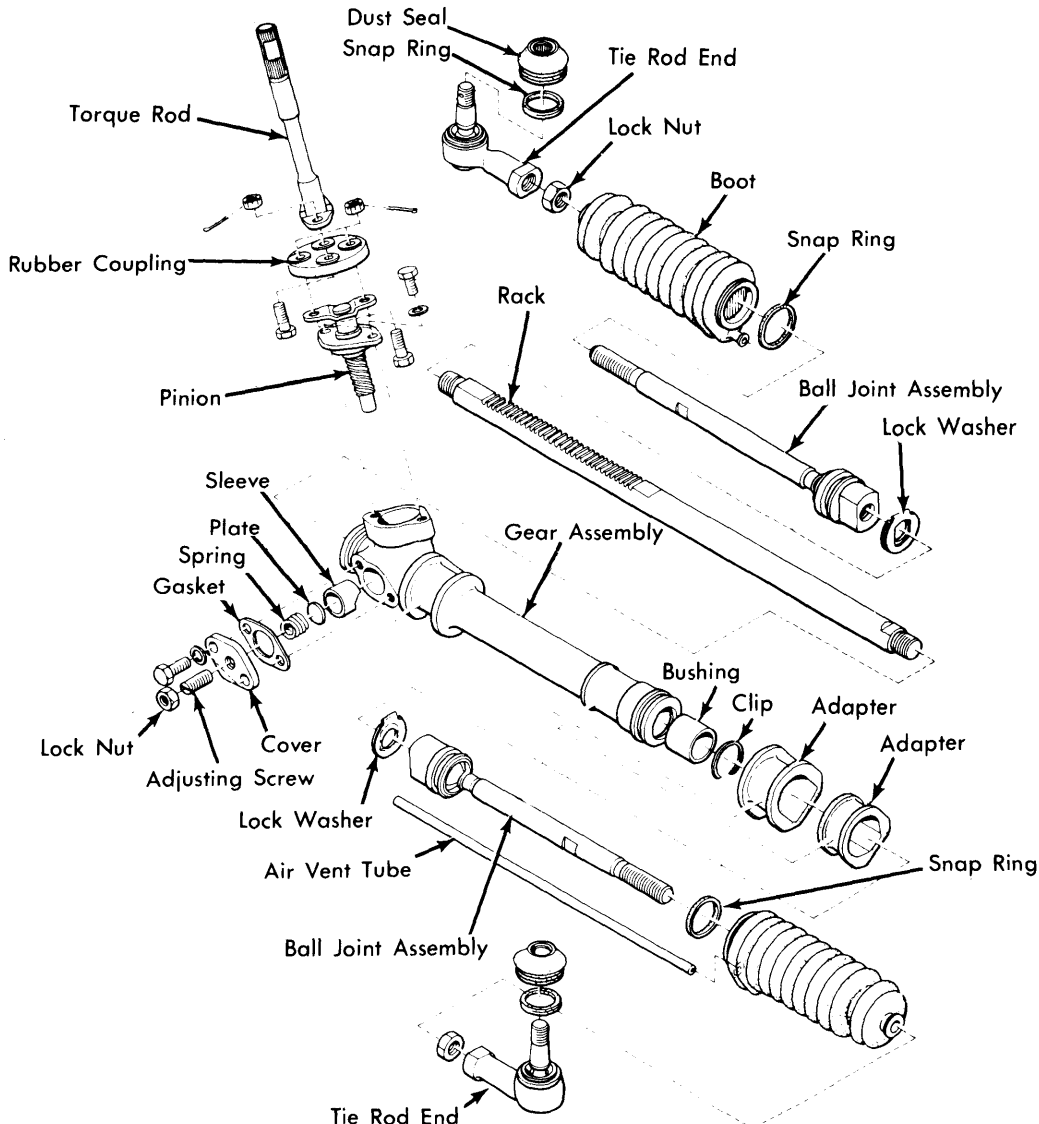

STEERING GEAR ASSEMBLY

2SU85

## 1972-73 SUBARU (Cont.)

### OVERHAUL

**Disassembly** – Loosen lock nuts and remove tie rod ends. Remove air vent tube from boots. Remove snap rings from boots and pull boots from gear housing. Straighten lock washers and remove ball joints from rack ends. Loosen lock nut, completely back out adjusting screw, then remove cover, gasket, sleeve spring, sleeve plate, and sleeve. Remove pinion from rack, then remove rack from gear housing.

**Inspection** – Steering rack should be straight within .010" (0.3 mm). Ball joint play should not exceed .010" (0.3 mm) at 154 lbs. (70 kg). Inspect all parts and replace if worn, damaged, or not within specifications.

**Reassembly** – 1) Grease the toothed and sliding portions of rack and install rack into gear housing. Locate end of rack so that it measures 2.87" (73 mm) from end of gear housing, then grease and install pinion. Tighten pinion assembly to gear housing. In this position, rack and pinion will be centered for vehicle straight-ahead position. When center position has been established, mark the gear housing and pinion with white paint so that marks will align for center position reference.

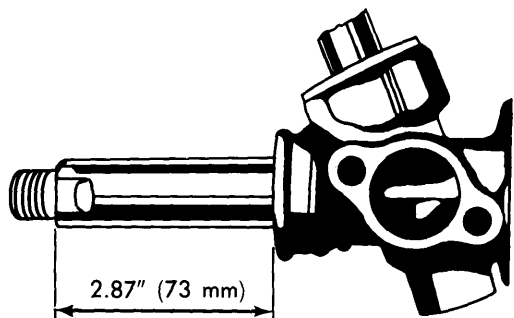

2SU87

### CENTERING RACK

2) Install sleeve, plate, spring, gasket, and cover to gear housing and tighten bolts. Turn adjusting screw in until it contacts plate and back off 1/8 turn to obtain .006" (0.16 mm) end play. Tighten lock nut. **NOTE** – Use a suitable locking compound on bolt and adjusting screw threads.

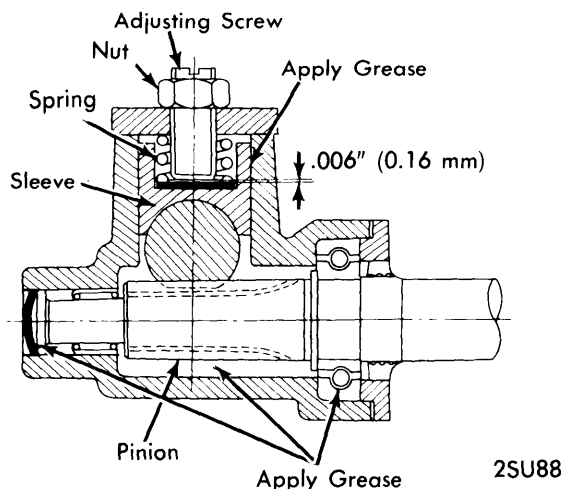

### BACKLASH ADJUSTMENT

3) Install lock washers and ball joints on rack ends. Tighten ball joints and bend lock washers over to secure joints. Install boots on gear housing and retain with snap rings. Install air vent tube into boots while aligning it with embossed mark on gear housing. Install tie rod ends with lock nuts, and temporarily tighten lock nuts. Rotate pinion and check operation of gear assembly. Pinion operating torque in straight ahead position should be less than 1.1 ft. lbs. (0.15 mkg) at ±1.18" (±30 mm) of rack displacement. Maximum torque should not exceed 1.59 ft. lbs. (0.22 mkg).

### TIGHTENING SPECIFICATIONS

Application	Ft. Lbs. (mkg)
Pinion Assembly Bolt .....	6-9 (0.8-1.2)
Adjuster Cover Bolt .....	6-9 (0.8-1.2)
Adjuster Lock Nut.....	14-18 (2.0-2.5)
Ball Joint.....	47-54 (6.5-7.5)
Gear Housing Mounting Bolts.....	33-40 (4.5-5.5)
Tie Rod End to Knuckle.....	①18-22 (2.5-3.0)
Tie Rod Lock Nut.....	58-65 (8.0-9.0)
Rubber Coupling Nut.....	①5.1 (0.7)

① – Tightening castellated nut to specified torque, then tighten additionally until cotter pin can be inserted.

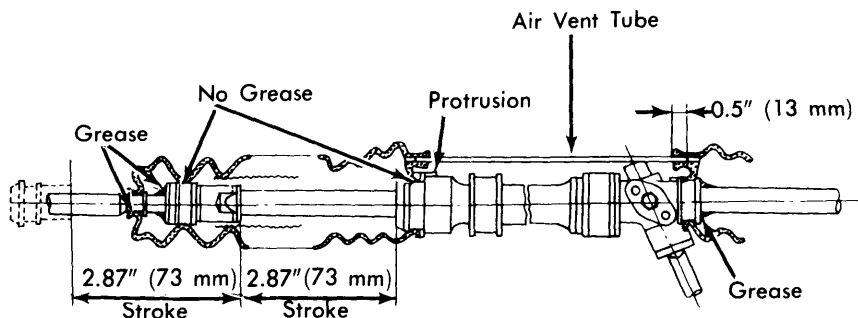

2SU86

### STEERING GEAR ASSEMBLY