

# Steering Gears & Linkage

## 1973 HONDA CIVIC

Civic (1973)

### ADJUSTMENT

#### STEERING RACK PLAY

Remove retaining bands and slide dust seals off left and right side of gear housing. Turn front wheels full left and, using your hand, attempt to move rack in up-and-down manner. Repeat with wheels turned to full right. If any movement is felt in rack, make the following adjustment:

Ensure gear is well lubricated. Loosen rack guide adjusting screw lock nut. Tighten adjusting screw just until front wheels cannot be turned by hand. Back off screw 45° and hold in that position while tightening lock nut. Recheck play, as described above. Move front wheels from lock-to-lock to make sure rack moves freely. Recheck steering force.

2) Remove tie rod ends from steering knuckles. Disconnect exhaust pipe at manifold. Detach gearshift rod and extension at engine. Ensure engine is properly supported and remove center member (leave center mount on engine).

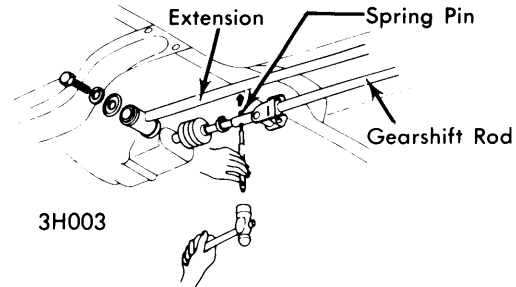

### DETACHING GEARSHIFT

### REMOVAL & INSTALLATION

#### STEERING GEAR

**Removal** — 1) Raise front of vehicle and support with safety stands. Remove front wheels. Attach suitable engine hoist (07966-6340010) to torque rod bolt and to bolt just left of distributor, and lift engine far enough to take load off engine mounts.

3) Turn steering wheel to full left position and remove steering "U" joint from pinion shaft. Unscrew steering gear retaining bolts. Bend left tie rod upward and lower the rack until pinion clears vehicle body. Rotate rack until pinion is facing down. Move rack toward right side of vehicle until left tie rod can be lowered out bottom. Remove rack through bottom of sub-frame.

**Installation** — To install, reverse removal procedure.

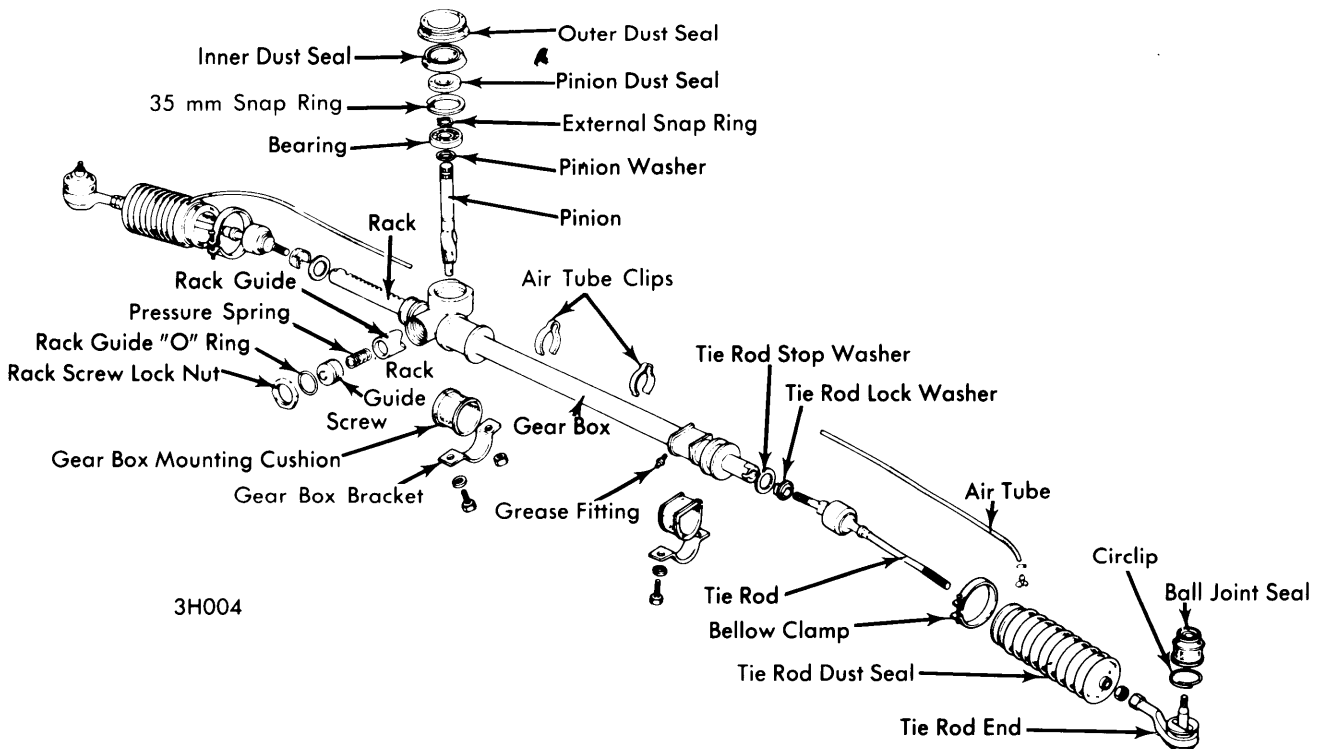

### HONDA RACK & PINION STEERING GEAR

## 1973 HONDA CIVIC (Cont.)

### OVERHAUL

#### STEERING GEAR

**Disassembly** — 1) Disconnect air tube at tie rod dust seal clamps and move rubber bellows to expose tie rod and rack joints. Straighten tie rod lock washer tabs. Remove both tie rods

2) Remove rack screw lock nut, rack guide screw, pressure spring, and guide. Rack guide can be removed with snap ring pliers, if necessary. Remove pinion dust seal by carefully prying around pinion shaft. **CAUTION** — Do not pry at outer edge, as housing will be damaged.

3) Remove large (35 mm) snap ring. Remove pinion and bearing from housing by holding pinion and lightly tapping housing with soft hammer. Remove snap ring retaining pinion bearing. To remove bearing, tap pinion with soft hammer while holding bearing.

**Inspection** — Check all components for wear and replace as necessary. Check tie rod moving force by attaching pull-scale as shown. Service limits are as follows: minimum-72. ft. lbs; maximum-2.89 ft.lbs

**Assembly** — Before assembling, coat each sliding component with grease, then reverse disassembly procedure, noting

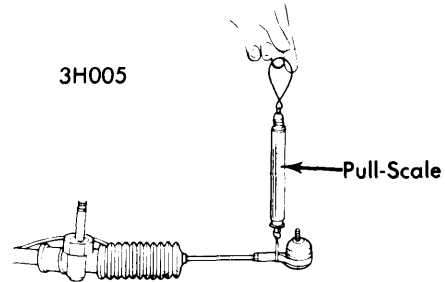

#### CHECKING TIE ROD MOVEMENT

the following: First install steering rack to gear box. Install pinion in place and mesh it with rack. Position internal snap ring and then a new pinion dust seal. Install rack guide in proper position (note contour of guide over rack). Position pressure spring, new "O" ring on guide screw, and install screw. Adjust rack guide screw as described under Adjustment.