

Steering Columns

1964-70 DATSUN 310, 311, 312, 410

Datsun 310 (1964-65)
 Datsun 311 (1966-70)
 Datsun 312 (1964)
 Datsun 410 (1964-65)

DESCRIPTION

Steering column used on these vehicles is of the conventional type, with the lower end of the column connected to the steering gear by means of a universal joint (310, 311, 410) or flexible coupling (312). Column housing tube is bolted to the firewall and supported on instrument panel.

REMOVAL & INSTALLATION

MODELS 310, 311, 410

Removal — Remove steering wheel and horn assembly as previously described. See *Datsun under STEERING WHEEL REMOVAL in this Section*. Remove upper end column retainer collar and collar retaining ring. Unbolt steering column from universal joint upper yoke and note position of yoke to column fixing slot. Pull column into passenger compartment to remove.

Installation — Reverse removal procedure, noting the following: Ensure column and upper universal yoke positions are exactly in original positions before inserting yoke pinch bolt.

MODEL 312

Removal — Remove steering wheel and horn assembly as previously described. See *Datsun under STEERING WHEEL REMOVAL in this Section*. Remove upper end column retainer collar and collar retaining ring. Unbolt flexible coupling through-bolts and remove flexible disc. Note position of fixing slot to coupling flange upper half. Pull column upward into passenger compartment.

Installation — Reverse removal procedure, noting the following: Ensure column and upper flexible joint position is in original position before installing through-bolts.

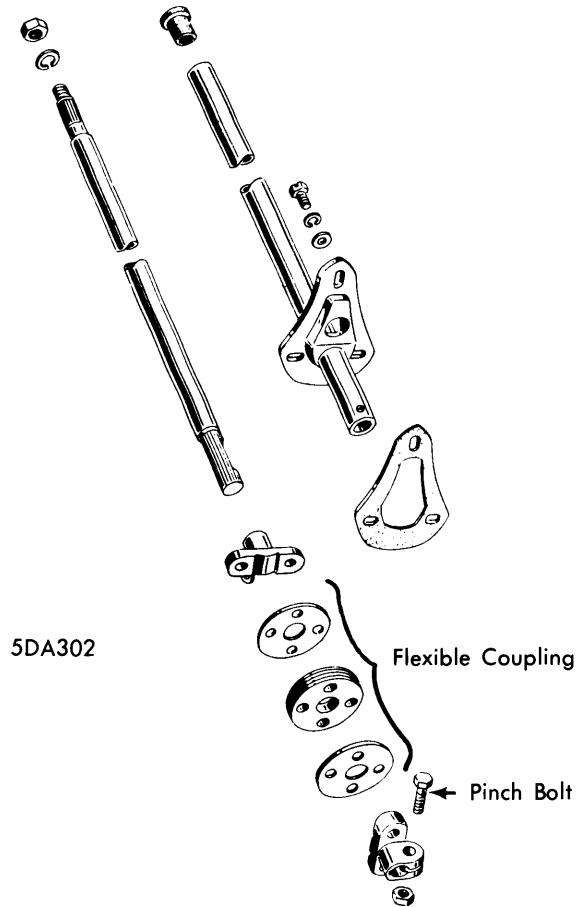

STEERING COLUMN ASSEMBLY — 310, 311, 410

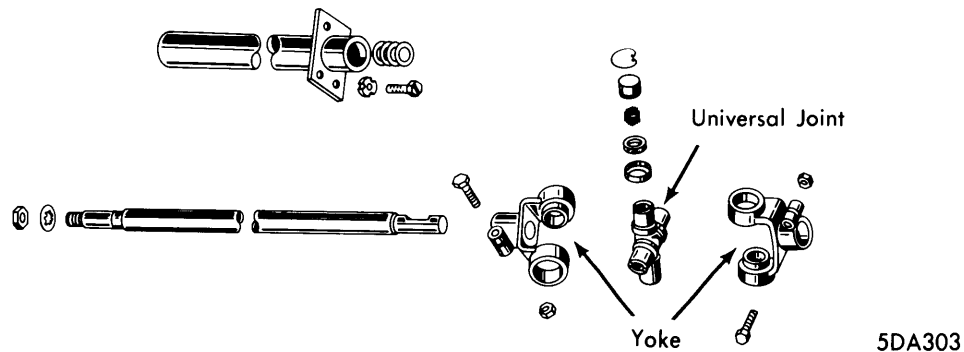

STEERING COLUMN ASSEMBLY — 312